



# HIGH PRESSURE WASHER



ITEM NO. 6524

INSTRUCTION MANUAL



**SPECIFICATION**

Model	<b>6524</b>
Power	1400 W
Voltage	230 V
Frequency	50 Hz
No Load speed	2800r/min
Max Pressure	110 bar
Rated Pressure	70 bar
Max. Flow	6.0 L/min
Rated Flow	5.0 L/min
Max. Inlet Pressure:	1.0 MPa
Protection Rating	IPX5
Max. Water Temperature	40 °C
Working temperature	F-Class/below155°C
Power Cord Length	5 m
Hose Length	5 m
Motor Type	Induction
Product Length	294 mm
Product Height	241 mm
Product Width	170 mm
Net weight	9.07 Kg
Gross weight	9.97 Kg
Accessories	GUN NOZZLE SOAP BOTTLE 5M HOSE 1/2 QUICK WATER INLET CONNECTOR FILTER

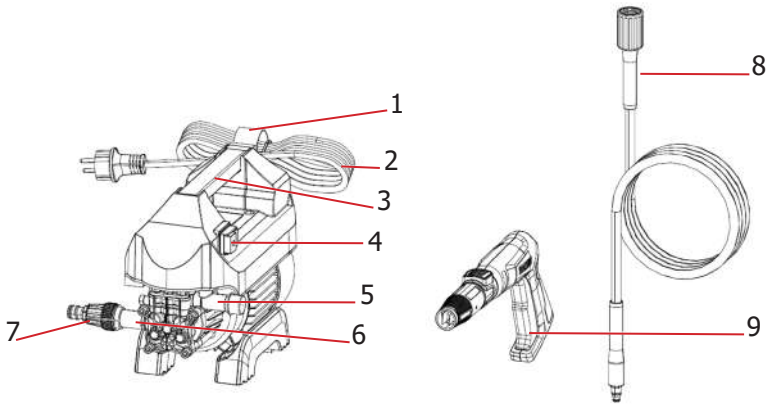
**PART LIST****Product Elements**

- 1 Power cord tie
- 2 Power cord
- 3 Handle
- 4 Adjust switch OFF/ON
- 5 Water outlet
- 6 Water inlet
- 7 Water inlet filter
- 8 High pressure hose
- 9 Trigger Spray

**SAVE THESE INSTRUCTIONS****WARNING!**

- ▷ Please read and comply with these original instructions prior to the initial operation of your appliance and store them for later use or subsequent owners.
- ▷ Apart from the notes contained herein the general safety provisions and rules for the prevention of accidents of the legislator must be observed.
- ▷ Warnings and notes that are attached on the appliance provide important notes for the safe operation.

**Hazard levels****DANGER!**

Pointer to immediate danger, if not avoided, which leads to severe injuries or death.

**WARNING!**

Pointer to a possibly dangerous situation, if not avoided, which can lead to severe injuries or death.

**CAUTION!**

Pointer to a possibly dangerous situation, if not avoided, which can lead to minor injuries.

**ATTENTION**

Pointer to a possibly dangerous situation, which can lead to property damage.

**Electrical connection****DANGER!**

- ▷ Risk of electric shock.
- ▷ Never touch the mains plug and the socket with wet hands.
- ▷ Check the power cord with mains Plug for damage prior to every use. Do not use the machine if a supply cord or important parts of the machine are damaged, e.g. safety devices, high pressure hoses, trigger gun.
- ▷ All current-conducting parts in the working area must be protected against jet water.
- ▷ The mains plug and the coupling of an extension cable must be watertight and must never lie in water.
- ▷ Moreover, the coupling may never lie on the ground. The use of cable reels that ensure that the sockets are at least 60 mm above the ground is commended.
- ▷ Make sure that the power cord or extension cable is not damaged by running over, pinching, dragging or the like. Protect the power cords from heat, oil, and sharp edges.
- ▷ Always switch off the mains disconnecting switch when leaving the appliance unattended.

**WARNING!**

- ▷ The appliance may only be connected to an electric supply that has been installed by an electrician in accordance with IEC 60364.
- ▷ The appliance may only be connected to alternate current. The voltage must correspond with the type plate of the appliance.
- ▷ For safety reasons, we recommend that you operate the appliance only via a residual current device (max. 30mA).

- ▷ An unsuitable electrical extension cable can be hazardous. Only use an electrical extension cable which has been approved and labeled for this purpose and has an adequate cable cross-section outdoors: 1 - 10 m: 1.5 mm<sup>2</sup>; 10 - 30 m: 2.5 mm<sup>2</sup>

## Safe handling



### DANGER!

- ▷ The user must be the appliance as intended. The person must consider the local conditions and must pay attention to other persons in the vicinity when working with the appliance.
- ▷ Check important components, such as high pressure hose, hand spray gun and safety installations, for damage prior to every operation. Immediately replace damaged components. Do not operate appliance with damaged components.
- ▷ The appliance has been designed for use with the cleaning agent supplied or recommended by the manufacturer. The use of the other cleaning agents or chemicals may adversely affect the safety of the appliance.
- ▷ High-pressure jets can be dangerous if subject to misuse. The jet must not be directed at persons, live electrical equipment or the machine itself.
- ▷ Do not direct the jet against yourself or others in order to clean clothes or foot-wear.
- ▷ Do not use the appliance within range of persons unless they wear protective clothing.
- ▷ Wear appropriate Personnel Protection Equipment (PPE) while operating the appliance



### WARNING!

- ▷ The appliance must not be operated by children or untrained personnel.
- ▷ This appliance is not intended for use by persons (including children) with reduced physical, sensory or mental capacities, or lacking experience and knowledge.

- ▷ Children must not play with this appliance.
- ▷ Supervise children to prevent them from playing with the appliance.
- ▷ Create stability for the appliance prior to any work on or with the appliance to prevent accidents damage.
- ▷ The water jet that is emitted from the high pressure nozzle results in a repulsion power acting on the hand spray gun. Make sure that you have a firm footing and are also holding the hand spray gun and spray lance firmly.
- ▷ Never leave the appliance unattended as long as it is in operation

## ATTENTION

In case of extended breaks, switch the appliance off at the main switch or pull the mains plug.

Do not operate the appliance at temperatures below 0°C

## Other risks



### DANGER!

- ▷ The appliance may not be operate in explosive atmospheres.
- ▷ Risk of explosion-Do not spray flammable liquids.
- ▷ Never draw in fluids containing solvents or undiluted acids and solvents! This includes petrol, paint thinner and heating oil. The spray mist is highly inflammable, explosive and poisonous. Do not use acetone, undiluted acids and solvents, as they corrode the materials used on the appliance.
- ▷ Never use the product with inflammable or toxic liquids, or liquids with characteristics incompatible with its proper operation.
- ▷ Keep packaging films away from children, there is a risk of suffocation!

 **WARNING!**

- ▷ According to applicable regulations, the appliance must never be used on the drinking water net without a system separator. Ensure that the connection of your building water installation on which the high pressure cleaner is operated is equipped with a system separator pursuant
- ▷ Water that has flown through back flow preventer's is considered to be non-potable.
- ▷ High-pressure hoses, fittings and couplings are important for the safety of the appliance. Only use high-pressure hoses, fittings and couplings recommended by the manufacturer.
- ▷ To ensure applicable safety, use only original spare parts from the manufacturer or approved by the manufacturer.
- ▷ Switch the product off and disconnect it from the power supply removing the power plug from the socket outlet before assembly, cleaning, adjustments, maintenance, storage and transportation or converting the product to another function.

 **CAUTION!**

Mind the weight of the appliance when selecting the storage location and during transport to prevent accidents or injuries.

Several hours of continuous use of the appliance can lead to numbness in the hands in rare cases.

- Wear gloves.
- Keep hands warm.
- Take breaks at regular intervals. Working with detergent

 **WARNING!**

- ▷ The improper use of detergents can cause severe injuries or oxidation.

- ▷ Store cleaning agent away from the reach of children.
- ▷ Discharge residual pressure before disconnecting the hose from the product.
- ▷ Check before each use, and at regular intervals, that all metal fasteners are tight and the product's components are in good condition; inspect for broken or worn parts.
- ▷ Be aware of kick-back: Hold With Both Hands.

## Residual risks

Even if you are operating this product in accordance with all the safety requirements, potential risks of injury and damage remain. The following dangers can arise in connection with the structure and design of this product:

Health defects resulting from vibration emission if the product is being used over long periods of time or not adequately managed and properly maintained.

Danger of injury and property damage caused by flying objects.

Injuries and damage to property due to broken accessories or the sudden impact of hidden objects during use.

## Safety Devices

 **CAUTION!**

Safety installations serve the protection of the user and may not be modified.

## Power switch

The appliance switch prevents unintentional operation of the appliance.

## Lock trigger gun

This lock locks the lever of the trigger gun and prevents the inadvertent start of the appliance.

Water that has flowed through back flow preventer's is considered to be non-potable.

## Personal protective equipment



### CAUTION!

Wear protective clothing and safety goggles to protect against splash back containing water or dirt.

- ▷ During the use of high-pressure cleaners aerosols can develop. Inhaling aerosols can cause health damage.
- ▷ Depending on the application, completely shielded nozzles (e.g. surface cleaner) that significantly reduce the emission of aqueous aerosols can be used for high-pressure cleaning.
- ▷ The use of such shielding is not possible with all applications.
- ▷ Symbols on the machine



The high pressure jet must not be directed at persons, animals, live electrical equipment or at the appliance itself



The appliance must not be directly connected to the public drinking water network.



Sound power level is 90dB(A)

## PROPER USE

This product may not be used to clean clothing, shoes and other textiles. The water jet should not be directed against persons. Animals, any electrical equipment or on the product itself. Do not flush any objects which contain health hazardous materials.

The product must not be run with inflammable, explosive and toxic liquids.

- ▷ For safety reasons it is essential to read the entire instruction manual before first operation and to observe all the instructions there in.

## ASSEMBLY

Mount loose parts delivered with appliance prior to start-up

### 1. Installing the spray nozzle

- ▷ Fit the spray nozzle into the trigger and rotate it until the two parts are completely locked.

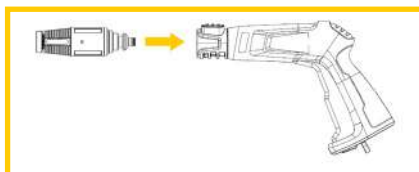

### 2. Connect the high pressure hose to the trigger spray

- ▷ Connect the sliver end of the high-pressure hose to the trigger spray and twist the nut as indicated to secure the connection.



### 3. Connect the high-pressure hose to the water outlet.

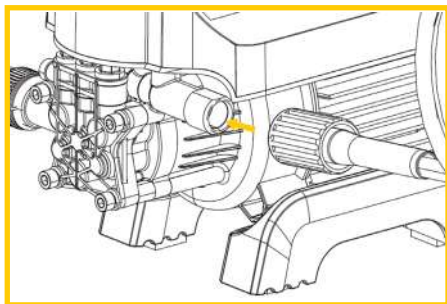

### 4. Connect the garden hose to the water inlet

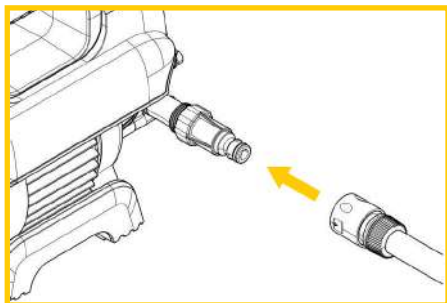

Connect the garden hose adapter (female coupler) to the water inlet of the pressure washer, then thread your garden hose (male end) into the garden hose adapter.

## START UP

Park the appliance on an even surface.

Insert the mains plug into the socket

## Water supply

### ATTENTION

Impurities in the water can damage the high-pressure pump and the accessories.

Attach garden hose to water supply.

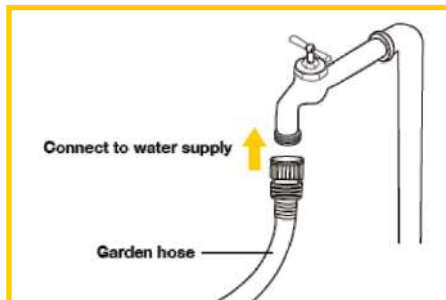

### CAUTION!

Do not connect to potable water system.

The water supply must not exceed 0.7MPa.

The washer must only be used with clean water, use of unfiltered water containing corrosive chemicals will damage the washer.

Bleed the device as follows prior to operation:

- ▷ Turn on the appliance "0/I"
- ▷ Unlock the lever of the trigger gun.
- ▷ Push the lever of the trigger gun, the device will switch on.
- ▷ Let the device run (max. 2 minutes) until the water exits the trigger gun without bubbles.
- ▷ Release the lever of the trigger gun.

## OPERATION

### ATTENTION

Dry running of more than 2 minutes leads to damage of the high-pressure pump. If the appliance does not build up pressure within 2 minutes, switch the appliance off and proceed in accordance with the instructions in Chapter "Troubleshooting"

### High pressure operation



### CAUTION!

Keep a distance of at least 30 cm when using the jet for cleaning painted surfaces to avoid damage.



### CAUTION!

Make sure the on/off switch is set to "0/I" position and insert the plug into a properly installed socket.

### ATTENTION

- ▷ The washer must be used on a secure and stable surface in a standing, upright position
- ▷ Connect the product to power and water supply as described.
- ▷ Open the water supply
- ▷ Hold the spray gun with both hands.
- ▷ Direct the nozzle of the chosen accessory away from you towards the surface to be cleaned.
- ▷ Unlock the trigger and press it until a constant amount of water flows through the nozzle, to allow air trapped in the hose to escape.
- ▷ Release the trigger.
- ▷ Turn on the switch "0/I".

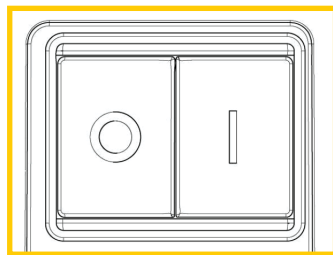

- ▷ Hold the spray gun with both hands. Direct the water jet to the object to be cleaned and press the trigger.

Release the lever of the trigger gun; the device will switch off again and stop the water jet. High pressure remains in the system.

**WARNING!** Beware of kickback when pressing the trigger!

### Interrupting operation

- ▷ Release the lever of the trigger gun.
- ▷ Lock the lever of the trigger gun.
- ▷ Put the trigger gun with the spray lance into the parking position.
- ▷ During longer breaks (more than 5 minutes), also turn the appliance off using the "0/I" switch.

### Finish operation

- ▷ Release the lever of the trigger gun.
- ▷ Turn off the appliance "0/I".
- ▷ Disconnect the mains plug from the socket.
- ▷ Only separate the high-pressure hose from the trigger gun or the device when there is no pressure in the system.
- ▷ Pressure the lever of the trigger gun to release any remaining pressure in the system.

- ▷ Pressure the lever of the trigger gun to release any remaining pressure in the system.
- ▷ Release the lever of the trigger gun.
- ▷ Lock the lever of the trigger gun.

### ATTENTION

- ▷ When disconnecting the supply or high pressure hose, warm water may leak from the connection after operation.
- ▷ Detach the appliance from the water supply.

### TRANSPORTATION



#### CAUTION!

Risk of personal injury or damage!

Mind the weight of the appliance during transport.

#### When transporting by hand

- ▷ Switch the product off and disconnect it from the water and power supply.
- ▷ Pull out the transport handle until it audibly snaps into place. Attach transportation guards, if applicable.
- ▷ Pull the appliance by its transport handle.

#### When transporting in vehicles

- ▷ Prior to horizontal transport: close the cap of clean detergent bottle.
- ▷ Tilt the product towards you until it balances on the wheels. Then move it by its transportation handle.

- ▷ Protect the product from any heavy impact or strong vibrations which may occur during transportation in vehicles.
- ▷ Secure the appliance against shifting and tipping over.

### STORAGE



#### CAUTION!

Risk of personal injury or damage!

Consider the weight of the appliance when storing it.

#### Storing the appliance

- ▷ Park the machine on an even surface.
- ▷ Detach spray lance from the trigger gun.
- ▷ Push the disconnect button on the trigger gun and pull the high-pressure hose out of the trigger gun.
- ▷ Place the trigger gun into the storage for the trigger gun.
- ▷ Put both spray lances into the storage for the spray lance.
- ▷ Dirt grinder spray lance: Nozzle towards the bottom.
- ▷ Coil the high-pressure hose and hang it over the hose storage.
- ▷ Store the mains connection in the accessory compartment.
- ▷ • Prior to extended storage periods, as during the winter, also observe the instructions in the care section.
- ▷ Always store the pressure cleaner, parts, and accessories in a place that is inaccessible to children. The ideal storage temperature is between 10 °C and 30 °C. Store the power washer indoors to prevent the water in the unit from expanding under freezing conditions.

- ▶ We recommend using the original package for storage or covering the product with a suitable cloth or enclosure to protect it against dust.

## Frost protection

### ATTENTION

Appliance and accessories that are not completely drained can be destroyed by frost

Completely drain appliance and accessories and protect them against frost. To avoid damage:

- ▶ Detach the appliance from the water supply.
- ▶ Detach spray lance from the trigger gun.
- ▶ Turn on the appliance "0/I" switch.
- ▶ Push the lever of the trigger gun until no more water is escaping .
- ▶ Release the lever of the trigger gun.
- ▶ Lock the lever of the trigger gun.
- ▶ Turn off the appliance "0/I" switch.
- ▶ Store the appliance and the entire accessories in a frost free room.

## CARE AND MAINTENANCE



### DANGER!

Risk of electric shock

Prior to all work on the appliance, switch off the appliance and pull the power plug.

## High pressure hose

The high pressure hose is specially constructed with reinforced walls it can be easily damaged and should be stored carefully.

- ▶ Do not kink.
- ▶ Do not drive vehicles over the hose.
- ▶ Do not expose the hose to sharp edges or corners. Misuse will lead to ballooning or premature failure and will invalidate warranty.

## Clean the sieve in the water connection

Clean the sieve in the water connection regularly.

Remove coupling from the water connection, and rinse with warm water to prevent any foreign matter from clogging the pump.

Remove the spray wand from the gun. Remove any dirt from the nozzle hole and rinse.

Clean the nozzle with the needle clean-out tool provided .

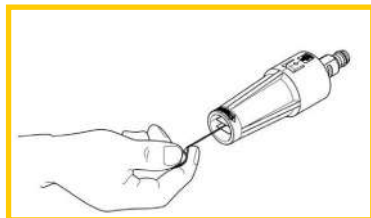

### ATTENTION

- ▶ The sieve must not be damaged.
- ▶ Pull the sieve out using flat pliers.
- ▶ Clean the sieve under running water.
- ▶ Reinsert the sieve into the water connection.

## ACCESSORIES

A choice of accessories is supplied in the scope of the delivery of this product. Please check the technical specification of any accessories that you purchase to ensure they are compatible with this product.

## WARRANTY

- ▶ This product has been manufactured to a high quality standard. The warranty period is 3 months from date of purchasing.
- ▶ For warranty service, please contact the present the warranty card and the original invoice for the warranty service.
- ▶ This warranty DOES NOT applies to: O-rings, seals, valves, nozzles, filters, damages to high pressure hose, gun, pump, motor, housing shells due to misuse, operation errors, or exposure to natural elements.
- ▶ Transportation damages after sales.
- ▶ Services not provided by our authorized service centers.
- ▶ Accessories and spare parts, if any, provided in the package.
- ▶ Damage resulted from commercial or industrial use, as this product is intended for DIY use only.

SYMPTOM	CAUSE	RECOMMENDED ACTION
Machine refuses to start	Machine not plugged in Defective socket Defective extension cord	Plug in machine Try another socket. Switch off other machines. Try without the extension cord.
Fluctuating pressure	Pump sucking air Valves dirty, worn out or stuck Pump seals worn out	Check that hoses and connections are airtight. Clean and replace or refer to local distributor Clean and replace or refer to local distributor
Machine stops	Incorrect mains voltage Thermal sensor activated Nozzle partially blocked	Check that the mains voltage corresponds to specification on the model tag. Leave the washer for 5 minutes to cool down. Clean the nozzle
Machine pulsating	Air in inlet hose Inadequate supply of mains water Nozzle partially blocked Water filter blocked Hose kinked	Allow machine to run with open trigger until regular working pressure resumes. Check that the water supply corresponds to specifications required NB! Avoid using long, thin hoses (min. 1/2"). Clean the nozzle /Clean the filter Straighten out hose.
Machine starts, but no water comes out	Pump/hoses or accessory frozen No water supply Water filter blocked / Nozzle blocked	Wait for pump/hoses or accessory to thaw. Connect inlet water. Clean the filter /Clean the nozzle

## سرویس و نگهداری

۱. قبل از استفاده حتما دستگاه را هواگیری نمایید.
۲. برای استفاده از سیستم شست و شو دقت داشته باشید ماده به صورت محلول باشد. هیچ گاه از پودر های شوینده استفاده نکنید. ذرات موجود در پودر ها وارد موتور شده و آسیب جدی به آن وارد می کند.
۳. برای استفاده از دستگاه از رابط برق استفاده نکنید.
۴. هیچ گاه دستگاه را به ژنراتور و مولد های برق وصل نکنید، نوسان برق آسیب جدی به دستگاه وارد می کند.
۵. در حین استفاده از دستگاه از قطع و وصل کردن های مکرر جدا بپرهیزید.
۶. از استفاده طولانی مدت از دستگاه جدا خودداری کنید.
۷. قبل از استفاده از تمیز بودن فیلتر توصیه مطمئن شوید.
۸. داخل کارتن دستگاه یک سوزن به منظور تمیز کردن نازل خروجی قرار داده شده است. قبل از استفاده از باز بودن مسیر خروجی آب مطمئن شوید.
۹. بعد از هر بار استفاده آب موجود داخل تفنگی، شلنگ ها و دستگاه باید تخلیه گردد. (رسوب موجود در آب می تواند به دستگاه آسیب جدی بزند.)
۱۰. دمای آب مصرفی از 40 درجه سانتی گراد نباید بیشتر باشد، زیرا دمای بیش از حد باعث خرابی قطعات دستگاه می شود.
۱۱. در صورت بروز هرگونه مشکل، به نمایندگی های مجاز مراجعه فرمایید.

راه حل پیشنهادی رفع مشکل	علت	علامت
<p>برق را متصل کنید</p> <p>کلید دستگاه را تعویض کنید</p> <p>سوکت جدیدی را جایگزین کنید</p> <p>دستگاه را نزد نمایندگی ببرید</p>	<p>برق دستگاه متصل نیست</p> <p>کلید دستگاه خراب است</p> <p>سوکت برق سوخته است</p> <p>موتور دستگاه سوخته است</p>	<p>دستگاه روشن نمی‌شود</p>
<p>بررسی کنید که شلنگ و اتصالات مهر و موم شده است.</p> <p>سوپاپ ها را تعویض یا تعمیر کنید</p>	<p>کاهش مکش دستگاه</p> <p>کثیف شدن سوپاپ دستگاه</p>	<p>فشار زیاد بر دستگاه</p>
<p>برق را متصل کنید</p> <p>کلید دستگاه را تعویض کنید</p> <p>سوکت جدیدی را جایگزین کنید</p> <p>دستگاه را نزد نمایندگی ببرید</p>	<p>فیوز ولتاژ اشتباهی به دستگاه وارد کرده است</p> <p>سنسور حرارتی فعال شده است</p> <p>نازل تا حدی مسدود شده است</p>	<p>توقف کار دستگاه</p>
<p>به نزدیک‌ترین خدمات گارانتی مراجعه کنید</p>	<p>پمپ / تفنگ اسپری نشستی دارد</p>	<p>دستگاه بی‌دلیل روشن و خاموش می‌شود</p>
<p>صبر کنید تا انجماد آن ها از بین برود</p> <p>دستگاه را به منبع آب مطمئن وصل کنید</p> <p>فیلتر آب را تعویض کنید</p> <p>نازل را تعویض کنید</p>	<p>پمپ / شلنگ منجمد شده‌اند</p> <p>منبع آب قطع است</p> <p>فیلتر آب مسدود شده است</p> <p>نازل مسدود شده است</p>	<p>دستگاه روشن می‌شود ولی آب از آن خارج نمی‌شود</p>

## ۴. نحوه اتصال شلنگ ورودی آب به ورودی کارواش

- ◀ ابتدا رابط شیشهای موجود در کارتن را به قسمت ورودی در پشت دستگاه وصل نمایید. (این رابط شیشهای دارای یک فیلتر تصویه نانو می باشد. هیچ گاه بدون فیلتر از دستگاه استفاده نکنید.)
- ◀ شیر آب را باز کرده و مطمئن شوید مانعی در شلنگ آب وجود ندارد. شیرآب را بسته، سپس شلنگ را به رابط شیشهای وصل نمایید.
- ◀ کوپلینگ ارائه شده را سر شلنگ آب نصب می کنیم و برای اتصال کوپلینگ به فیلتر شیشهای، سر زرد رنگ کوپلینگ را به عقب می کشیم و آن را نصب می کنیم.

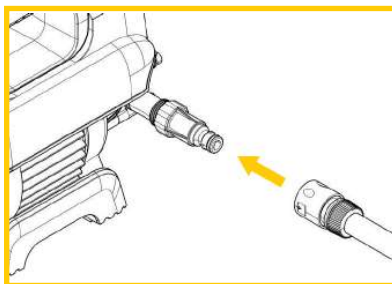

## ۵. هواگیری

- ◀ پس از نصب تمامی موارد بالا دستگاه را به برق وصل نکنید.
- ◀ شیر آب را باز کنید، ماشه تفنگی را بفشارید تا هوای داخل موتور و شلنگ ها خارج گردد و آب وارد مدار شود.

## ۶. شروع به کار

- ◀ دستگاه را به برق وصل کنید و با قرار دادن کلید در وضعیت روشن (ON) از استفاده آن لذت ببرید.

## هشدار ها

- ◀ قبل از استفاده از دستگاه دستورالعمل ها را به دقت بخوانید.
- ◀ عدم پیروی از دستورالعمل های ارائه شده ممکن است به آتش سوزی، شوک الکتریکی و یا آسیب جدی منجر شود.
- ◀ قطع اتصال از منبع برق قبل از انجام هرگونه تعمیرات ضروری است.
- ◀ عدم استفاده از دستگاه توسط کودکان و افراد غیر متخصص.
- ◀ تفنگ اسپری را به صورتی پایدار و محکم نگه دارید و در هنگام کار با دستگاه توصیه می کنیم افراد دیگر حداقل 10 متر فاصله بگیرند.
- ◀ مطمئن شوید که اسید یا مایعات قابل اشتعال در مخزن دستگاه استفاده نمی شود.
- ◀ دستگاه در برابر یخ زدن محافظت شود.
- ◀ قبل از شروع کار در آب و هوای سرد، مطمئن شوید قسمت های مختلف دستگاه یخ نزده باشد.
- ◀ استفاده از دستگاه در حالت خشک و بدون آب ممکن است آسیب های جدی به آن وارد کند.
- ◀ شلنگ آب حداقل 5/12 میلی متر در قطر با طول 5/7 متر توصیه می گردد.
- ◀ با توجه به املاح موجود در آب شهری جهت جلوگیری از رسوب و محافظت بیشتر دستگاه قبل از هر بار استفاده با سوزن مخصوص نسبت به تمیز کردن نازل دستگاه به شکل زیر اقدام فرمایید.

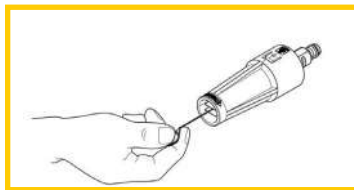

## راهنمای عیب یابی دستگاه

- ◀ زمانی که دستگاه دچار مشکل شد و از کار افتاد، اولین کاری که باید انجام داد خاموش کردن دستگاه و قطع برق دستگاه می باشد. سپس شیر آب را از دستگاه جدا نمایید.
- ◀ در صورت بروز مشکل در موتور دستگاه، بهتر است دستگاه را نزد نمایندگی مجاز ببرید.
- ◀ اگر دستگاه کار نمی کند اما عملکرد عادی نداشت باید از اتصال مناسب برق به دستگاه و همچنین اتصال مناسب به شیر آب مطمئن شد.
- ◀ از سالم بودن شلنگ و سر شلنگ های متصل شده اطمینان حاصل کنید



## کاربرد

کاربرد: این دستگاه برای شستن فرش، کف و سرامیک، پنجره ها، نمای ساختمان ها، اتومبیل ها، سرویس های بهداشتی، رستوران ها، آشپز خانه ها، ادارات، تالار ها، هیئت های مذهبی، مساجد، ویلاها و برج ها، برف رویی و آبیاری درختان و مزارع و ... قابل استفاده است.

## ویژگی

### سیستم شست و شوی ویژه

برای استفاده از این سیستم، ابتدا مایع شست و شوی مورد نظر را درون مخزن شست و شوی ارائه شده روی دستگاه ریخته و درب آن را ببندید (دقت داشته باشید هیچ گاه از موارد پودری استفاده نکنید. زیرا ذرات وارد موتور شده و به دستگاه آسیب جدی وارد می کنند.) و آن را روی تفنگ مستقیماً نصب نمایید.

### فشار شکن

این سیستم می تواند همزمان کار در فشار بالا (موثر) و فشار کم را تأمین کند. ابتدا در پشت دستگاه، درپوش مایع مخزن را برداشته، سپس شلنگ همراه آن را از داخل مخزن مایع خارج کنید. با چرخاندن قسمت دوم نازل می توانید همزمان از فشار بالا (مثلاً برای شست و شو حیاط) و فشار پایین (مثلاً برای آبیاری گلدان) بهره ببرید، و نیازی به جدا کردن مجدد آب شهری ندارید.

### خصوصیات دستگاه

- ◀ قدرت بالا، وزن مناسب، قابلیت حمل در همه مکان ها
- ◀ دارای فیلتر تصفیه نانو برای جلوگیری از ورود ذرات موجود در آب
- ◀ سیستم قطع و وصل سریع (YSS)
- ◀ صرفه جویی تا 70% در مصرف آب (TEM)
- ◀ قابلیت کار با آب گرم تا 40 درجه سانتی گراد
- ◀ مجهز به کوپلینگ اتصال سریع ورودی آب

## مونتاژ

### ۱. نصب نازل

◀ نازل را روی تفنگ نصب کرده و تا حد امکان از سفت بودن آن اطمینان حاصل نمایید.

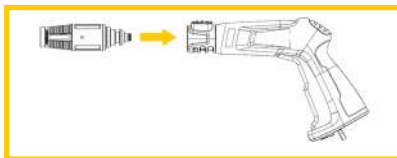

### ۲. اتصال شلنگ فشار قوی به تفنگ

◀ سری فلزی نقره‌ای رنگ را داخل شیراز زیر تفنگ وارد کرده و از اتصال کامل آن اطمینان حاصل نمایید.

◀ دقت کنید شلنگ در طول مسیر خود خمیدگی نداشته باشد.

◀ با چرخش قسمت جلوی نازل می‌توانید نوع شکل پاشش آب را به دلخواه تغییر دهید. (پخش یا متمرکز)



### ۳. اتصال سر شیلنگ فشار قوی به خروجی سر پمپ

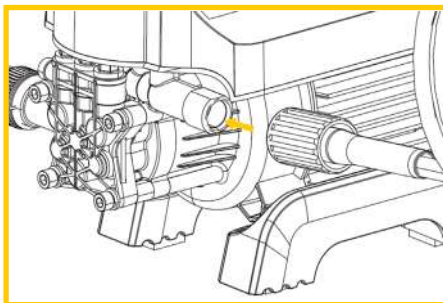

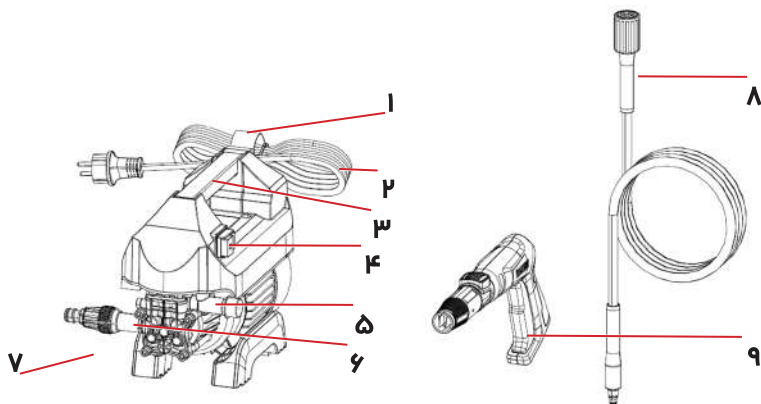

## اجزای تشکیل دهنده

- 1 بست کابل برق
- 2 کابل برق
- 3 دسته
- 4 کلید روشن-خاموش
- 5 خروجی آب
- 6 ورودی آب
- 7 کوپلینگ ورودی آب
- 8 شلنگ فشار قوی
- 9 شاسی تفنگ

## مشخصات فنی

مدل	6524
توان	۱۴۰۰ وات
ولتاژ	۲۳۰ ولت
فرکانس	۵۰ هرتز
سرعت بی باری	۲۸۰۰ دور بر دقیقه
حداکثر فشار	۱۱۰ بار
فشار کاری	۷۰ بار
حداکثر جریان خروجی	۶ لیتر بر دقیقه
نرخ جریان خروجی	۵ لیتر بر دقیقه
حداکثر فشار ورودی	۱ مگاپاسکال
کلاس محاقظت	IPX۵
حداکثر دمای آب	۴۰ درجه سانتیگراد
دمای کاری	کلاس F/زیر ۱۵۵ درجه سانتیگراد
طول سیم	۵ متر
طول شیلنگ	۵ متر
نوع موتور	دینامی
طول ابزار	۲۹۴ میلی‌متر
ارتفاع ابزار	۲۴۱ میلی‌متر
عرض ابزار	۱۷۰ میلی‌متر
وزن خالص	۹/۰۷ کیلوگرم
وزن کل	۹/۹۷ کیلوگرم
متعلقات	تفنگ نازل شلنگ فشار قوی مخزن کف پاش فیلتر کوپلینگ اتصال ۱/۲





## کارواش ۱۱۰ بار



ITEM NO. 6524

دفترچه راهنمای فارسی